



REGISTRATION NUMBER

DVH 0406

DATE OF REGISTRATION/PUBLICATION

07 **28** **2009**
Month Day Year

DO NOT WRITE ABOVE THIS LINE. IF YOU NEED MORE SPACE, USE A SEPARATE CONTINUATION SHEET. (Form D-VH/CON)

1

TITLE

Please give the make and model of the vessel that embodies the design.

Delta Project Number 156036

2

DESIGN

Check here if this is a single design.

Check here if registering more than one design. Use Form D-VH/CON for additional designs.

(a)

What is the type or style of the design for which registration is sought?

156' LOA tri-deck pleasure yacht with twin diesel/screw propulsion, and a semi displacement hull form

(b)

Provide a brief general statement setting forth the salient features of the design.

Exterior Description: A tri-deck configuration, with aft machinery space and fishing cockpit in a semi displacement, shallow draft hull with partial propeller tunnels, raked and flared bow with upper spray chine and rounded forward underbody that forms a transition to a chined underbody aft of amidships, and a straight buttock run with variable deadrise.

(c)

If this design is derived from an earlier design, describe how that design has been revised, adapted, or rearranged.

The basic hull form was originally developed for a prior 147' tri-deck pleasure yacht. The current design represents a lengthened hull design with a new sheer line. In addition, the deck house and superstructure constitute a wholly new design.

3

DESIGNER(S)

Provide the name and address of the designer(s). The name of the employer may be given instead of the designer(s) if, (1) the design was made within the regular scope of employment of the designer(s) and (2) the individual authorship of the design is difficult or impossible to ascribe.

Please check here if those conditions are satisfied and you are providing the employer's name.

Name: Delta Marine Industries, Inc.

Name: _____

Address: 1608 S. 96th Street
Seattle, WA 98108

Address: _____

4

OWNER, IF NOT DESIGNER(S)

If the owner is different from the designer(s) or employer named above, provide the name and address of the owner:

Name: _____

Address: _____

5

PRIORITY CLAIM

(a)

Was an application for registration of this design identified in an application filed in a foreign country that extends to designs of owners who are citizens of the United States, or to persons filing applications in the United States, similar protection to that afforded in 17 USC chapter 13?

Yes No

(b)

If yes, identify the country and date of application:

Country: _____

Date of application: _____

Serial No: _____

6

DATE MADE PUBLIC

Was this design made public before the date of application? Yes No

If yes, on what date? August

1

2008

Month

Day

Year

DO NOT WRITE HERE OFFICE USE ONLY

APPLICATION RECEIVED

MAY 29 2009
DESIGN COPIES RECEIVED

FUNDS RECEIVED

MORE ON BACK

• Complete all applicable spaces (numbers 7-9) on the reverse side of this page.
• See detailed instructions. • Sign the form at section 9.

DO NOT WRITE HERE
Page 1 of _____ pages

EXAMINED BY JH FORM D-VH

CHECKED BY

CORRESPONDENCE

Yes

FOR
COPYRIGHT
OFFICE
USE
ONLY

DO NOT WRITE ABOVE THIS LINE. IF YOU NEED MORE SPACE, USE A SEPARATE CONTINUATION SHEET. (Form D-VH/CON)

7
CONTACT
PERSON

Please provide the name and address of the person to whom correspondence regarding this application may be directed:

Name: Stephen M. Evans

Address: 155 108th Ave. NE, Ste. 350

Bellevue, WA 98004

Email address sevans@graybeal.com

FAX number 425-455-1046

Daytime phone: (425) 455-5575

8
DEPOSIT
ACCOUNT

Give the name and account number if the registration fee is to be charged to a deposit account established in the Copyright Office:

Name of Account: _____

Account number: _____

9

CERTIFICATION AND
SWORN STATEMENTS

DECLARATION: The undersigned, as the applicant or the applicant's duly appointed agent or representative, being hereby warned that willful false statements are punishable by fine or imprisonment, or both, under 18 USC §1001, and that such willful false statements may jeopardize the validity of this application or any resulting registration, hereby declares to the best of his or her knowledge and belief:

- (1) that the design has been fixed in a useful article;
- (2) that the design is original and was created by the designer(s), or employer if applicable, named in the application;
- (3) that those aspects of the design for which registration is sought are not protected by a design patent;
- (4) that the design has not previously been registered on behalf of the applicant or applicant's predecessor in title; and
- (5) that the applicant is the person entitled to protection and to registration under chapter 13 of title 17, *United States Code*.

Complete if applicable:

The design has been made public with a design notice as prescribed by 17 USC §1306.

Following is the exact form of the design notice:

Where on the useful article is the design notice located?

If the undersigned is not the applicant, he or she is properly authorized to execute this application on behalf of the applicant.

Signature

Stephen M. Evans

Print or type name

425-455-5575

Telephone number

425-455-1046

Fax number

21 May 2009

Date

Attorney

Position or title

sevans@graybeal.com

Email address

Copyright Office fees are subject to change. For current fees, check the Copyright Office website at www.copyright.gov, write the Copyright Office, or call (202) 707-3000.

Certificate will be mailed in window envelope to this address:

Name ▼	Stephen M. Evans
Number/Street/Apt ▼	155 108th Ave. NE, Ste. 350
City/State/Zip ▼	Bellevue, WA 98004

YOU MUST:

- Complete all necessary spaces
- Sign your application in space 9

SEND ALL 3 ELEMENTS IN THE SAME PACKAGE:

1. Application form
2. Nonrefundable filing fee in check or money order payable to *Register of Copyrights*
3. Design material

MAIL TO:

Dept. D-VH
Vessel Hull Registration
PO Box 71380
Washington, DC 20024-1380

17 USC §1327. **Penalty for false representation.** "Whoever knowingly makes a false representation materially affecting the rights obtainable under this chapter for the purpose of obtaining registration of a design under this chapter shall pay a penalty of not less than \$500 and not more than \$1,000, and any rights or privileges that individual may have in the design under this chapter shall be forfeited."

REGISTRATION NUMBER

DATE OF REGISTRATION/PUBLICATION

CONTINUATION SHEET RECEIVED

MAY 29 2009

DO NOT WRITE ABOVE THIS LINE. FOR COPYRIGHT OFFICE USE ONLY.

- Check here, if using for multiple designs: Fill in Space A ONLY with new information regarding additional designs. All other information must be identical to the information on the corresponding Form D-VH. Use an additional Form D-VH/CON for each design included in the registration.
Design _____ of _____ designs.
- Check here, if you are using the continuation sheet for supplemental information regarding the original design.

Identification of Application

IDENTIFICATION OF CONTINUATION SHEET: This is a continuation of the application for copyright registration on Form D-VH. Identify the title of the work as it appears in **Space 1** (i.e., make and model of the vessel) of Form D-VH:

Delta Project Number 156036

A

Continuation of Space 2

(2a) What is the type or style of the design for which registration is sought?

(2b) Provide a brief general statement setting forth the salient features of the design.

External deeply set elliptical shaped portholes in hull side to provide natural light to crew and guest areas. Bulwark freeing ports with similar elliptically shaped ends. Forward hull windows in stylized bullet shape with dark painted mullions to create a singular design element. Perimeter of window element connects to hull surface in a beveled perimeter transition. Forward coachroof and top of bulwark join just forward of the hull window to create a deep set crease that "enters" the bullet shaped window element at the leading end and emerges from the trailing end to form a split fashion plate. Another deep set crease begins above the hull window element and carries aft and across the back

(2c) If this design is derived from an earlier design, explain how that design has been revised, adapted, or rearranged.

REGISTRATION NUMBER

DATE OF REGISTRATION/PUBLICATION

CONTINUATION SHEET RECEIVED

MAY 29 2009

DO NOT WRITE ABOVE THIS LINE. FOR COPYRIGHT OFFICE USE ONLY.

- Check here, if using for multiple designs: Fill in Space A **ONLY** with new information regarding additional designs. All other information must be identical to the information on the corresponding Form D-VH. Use an additional Form D-VH/CON for each design included in the registration.
Design _____ of _____ designs.
- Check here, if you are using the continuation sheet for supplemental information regarding the original design.

Identification of Application

IDENTIFICATION OF CONTINUATION SHEET: This is a continuation of the application for copyright registration on Form D-VH. Identify the title of the work as it appears in **Space 1** (i.e., make and model of the vessel) of Form D-VH:

Delta Project Number 156036

A

Continuation of Space 2

(2a) What is the type or style of the design for which registration is sought?

(2b) Provide a brief general statement setting forth the salient features of the design.
of the upper deck bulwark. Engine room air inlets set in beveled perimeter with oval section polished stainless steel longitudinal grille work. Upper and lower aft fashion plates with similar style curved and sloped profile shapes with stepped surfaces with beveled and inset leading and lowed edges. Deckhouse sides on main and upper level have single window elements with rectangular shape and rounded corners. Windows in main saloon have sill heights hidden below the bulwark line. Forward pilothouse windows with sloped front and declining slope on side windows transition to slight tumblehome aft of port and starboard pilothouse doors. Upper coach roof forming top of pilothouse is a

(2c) If this design is derived from an earlier design, explain how that design has been revised, adapted, or rearranged.

REGISTRATION NUMBER

DATE OF REGISTRATION/PUBLICATION

CONTINUATION SHEET RECEIVED

MAY 29 2009

DO NOT WRITE ABOVE THIS LINE. FOR COPYRIGHT OFFICE USE ONLY.

Check here, if using for multiple designs: Fill in Space A ONLY with new information regarding additional designs. All other information must be identical to the information on the corresponding Form D-VH. Use an additional Form D-VH/CON for each design included in the registration.

Design _____ of _____ designs.

Check here, if you are using the continuation sheet for supplemental information regarding the original design.

**Identification
of
Application**

IDENTIFICATION OF CONTINUATION SHEET: This is a continuation of the application for copyright registration on Form D-VH. Identify the title of the work as it appears in Space 1 (i.e., make and model of the vessel) of Form D-VH;

Delta Project Number 156036

A

**Continuation
of Space 2**

(2a) What is the type or style of the design for which registration is sought?

(2b) Provide a brief general statement setting forth the salient features of the design.

surface joined to bulwark fairing around perimeter of sun deck. Leading edge and planform of upper and lower fairing in same family of curved shapes with sharp leading edges in profile, and stepped and sloped trailing edges with similar stepped creases around trailing edges. This sun deck fairing joins an arch that spans across sun deck, forming a support for the upper arch (arch upon arch design) that carries two radar platforms extending forward. Both respective radar platforms in planform incorporate port and starboard delta-wings that extend past the upper arch at each radar level. Four dome antennas carried, two on the top of the upper arch, port and starboard, and two on wing shaped

(2c) If this design is derived from an earlier design, explain how that design has been revised, adapted, or rearranged.

REGISTRATION NUMBER

DATE OF REGISTRATION/PUBLICATION

CONTINUATION SHEET RECEIVED

MAY 29 2009

DO NOT WRITE ABOVE THIS LINE. FOR COPYRIGHT OFFICE USE ONLY.

Check here, if using for multiple designs: Fill in Space A **ONLY** with new information regarding additional designs. All other information must be identical to the information on the corresponding Form D-VH. Use an additional Form D-VH/CON for each design included in the registration.

Design _____ of _____ designs.

Check here, if you are using the continuation sheet for supplemental information regarding the original design.

Identification of Application

IDENTIFICATION OF CONTINUATION SHEET: This is a continuation of the application for copyright registration on Form D-VH. Identify the title of the work as it appears in **Space 1** (i.e., make and model of the vessel) of Form D-VH:

Delta Project Number 156036

A

Continuation of Space 2

(2a) What is the type or style of the design for which registration is sought?

(2b) Provide a brief general statement setting forth the salient features of the design.

platforms that extend outboard from the lower arch, near the arch base. Aft main deck joins the fishing cockpit level via a centerline stairway, with curved surfaces outboard that sweep into the hull side surface. Access to swim platform via two stairs, port and starboard respectively, with center curved and sloped transom element and curved and sloped "shoulders" outboard that sweep into hull surface at sides.

Interior Description: Please see the included deck plans

(2c) If this design is derived from an earlier design, explain how that design has been revised, adapted, or rearranged.

Continuation of (check which): Space 3 Space 4 Space 5 Space _____

B

**Continuation
of Spaces
Other than
Space 2**

**MAIL
TO**

**Certificate
will be
mailed in
window
envelope**

Name	Stephen M. Evans
Number / Street / Apt	155 108th Ave. NE, Ste. 350
City / State / Zip	Bellevue, WA 98004

YOU MUST:

Complete all necessary spaces

**SEND ALL ELEMENTS
IN THE SAME PACKAGE:**

- 1 Application form
- 2 Nonrefundable filing fee in check or money order payable to *Register of Copyrights*

MAIL TO:

Dept D-VH
Vessel Hull Registration
PO Box 71380
Washington, DC 20024-1380

C

**Address for
return of
certificate**

DVH 0406

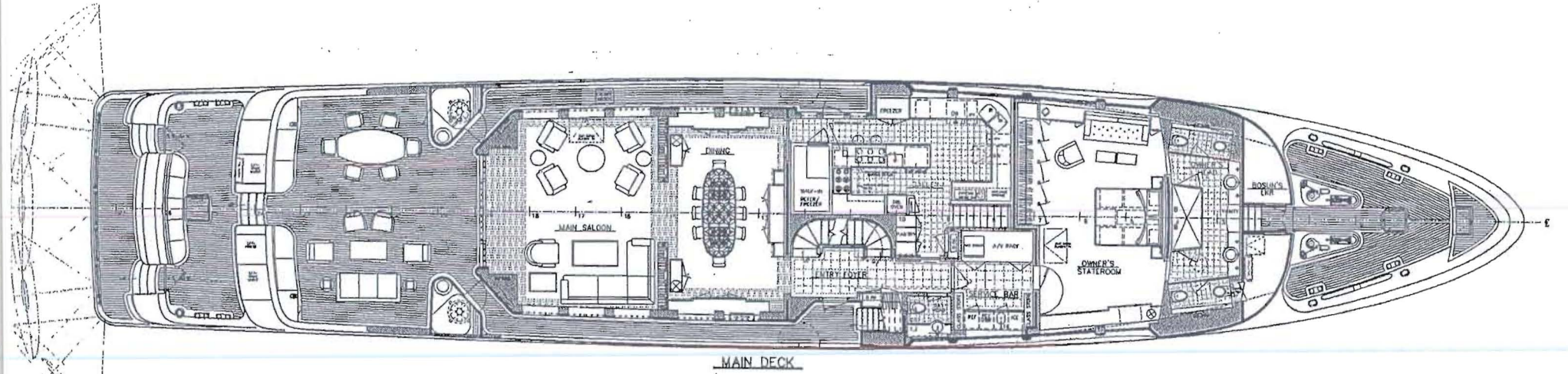

MAIN DECK

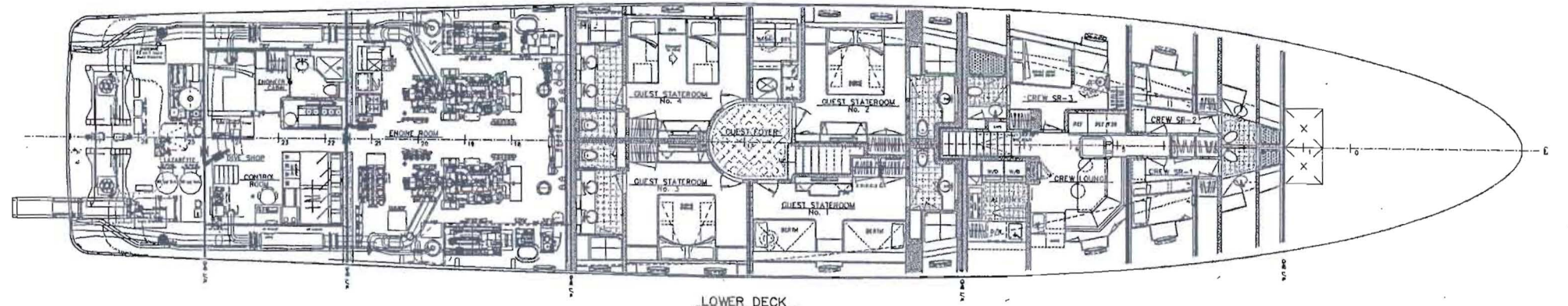

LOWER DECK

DVH 0406

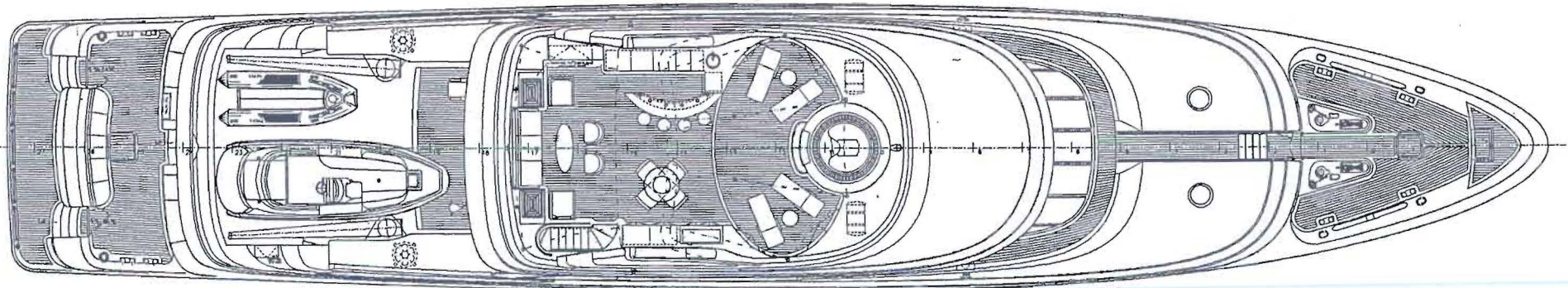

SUN DECK

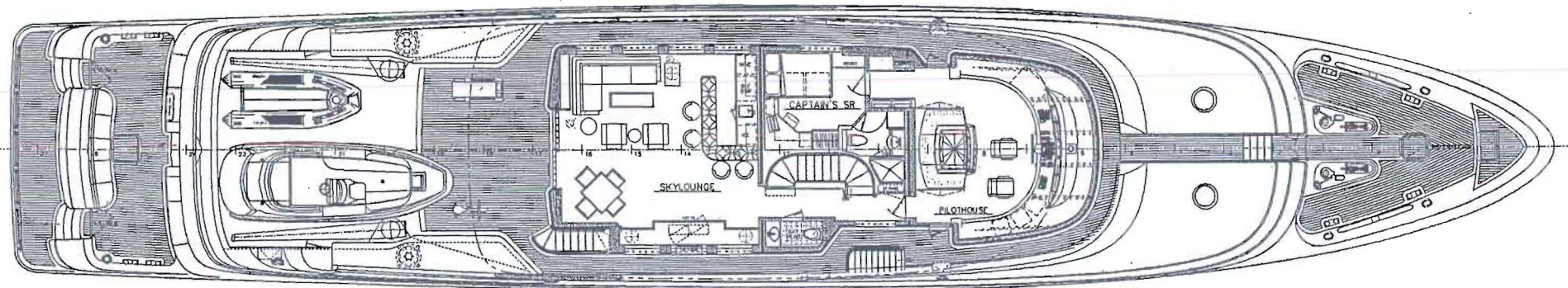

UPPER DECK

DVH 0406

LIBRARY OF CONGRESS
MAY 29 2009 23
COPYRIGHT OFFICE

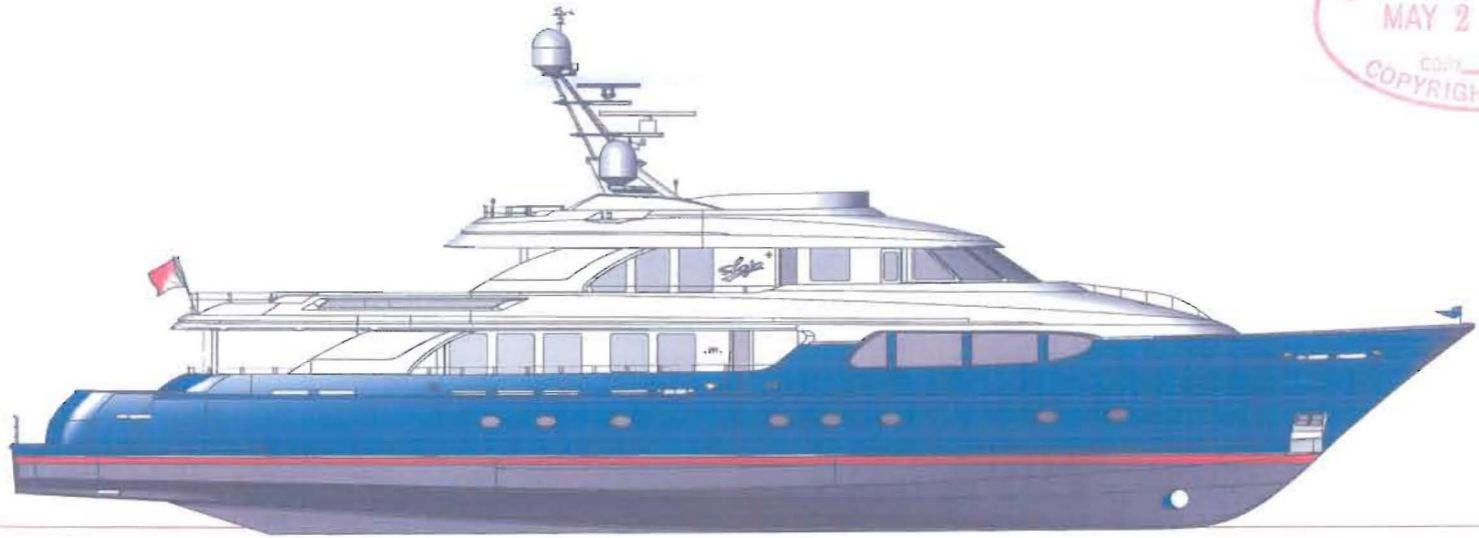

DVH 0406

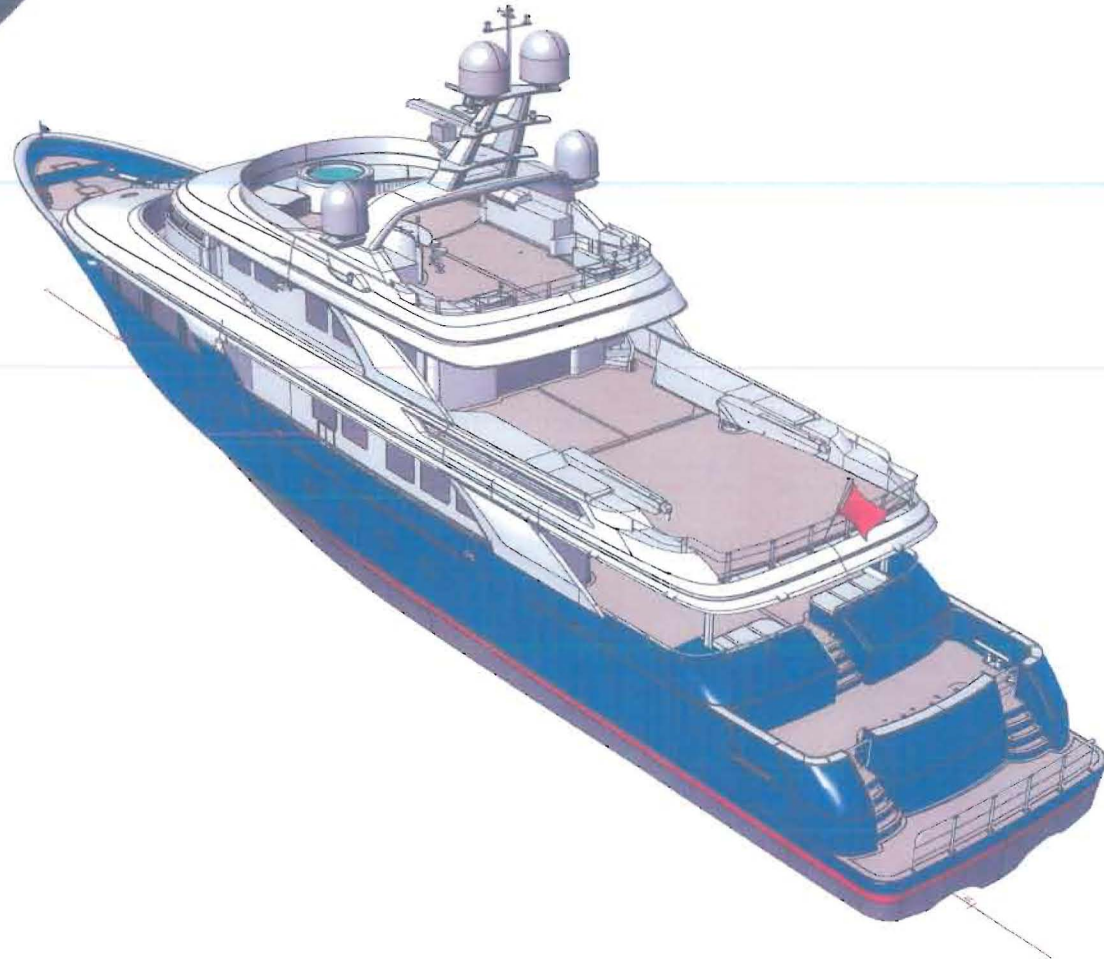
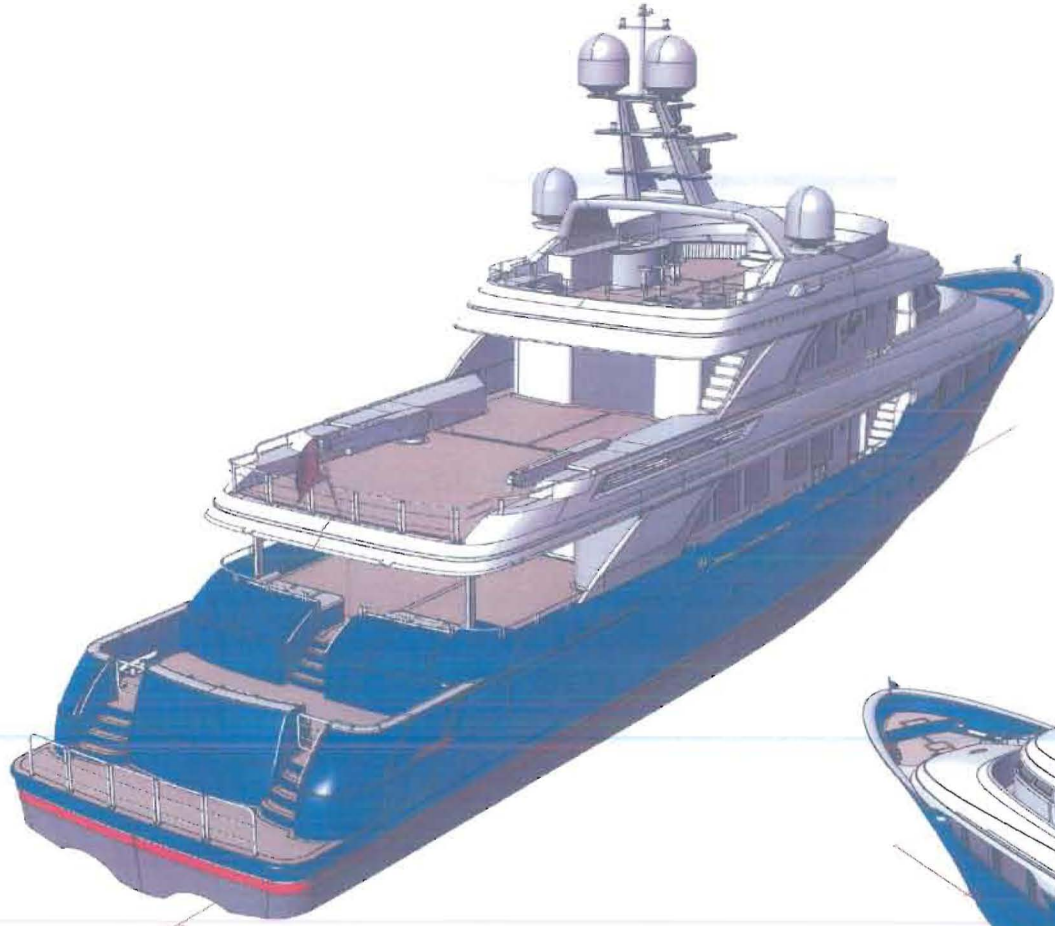

DVH 0406

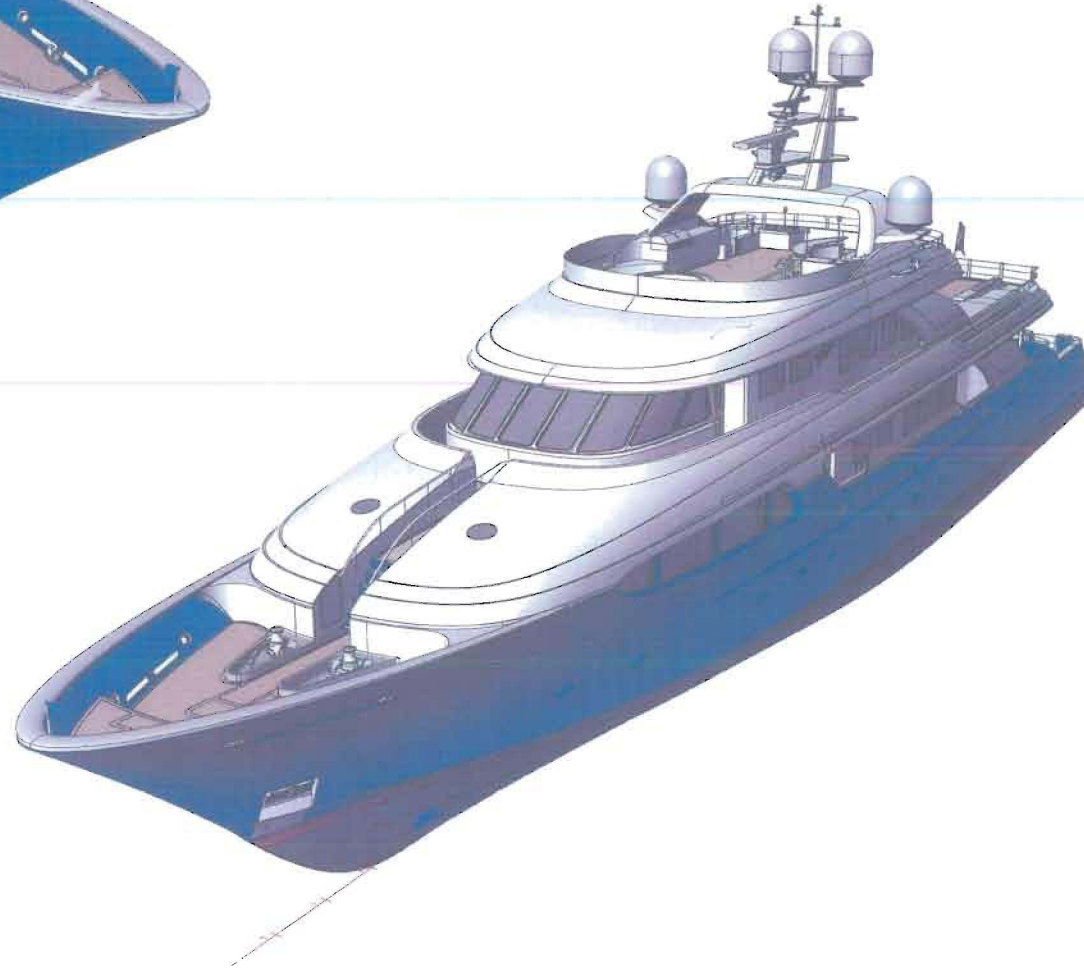

DVH 0406

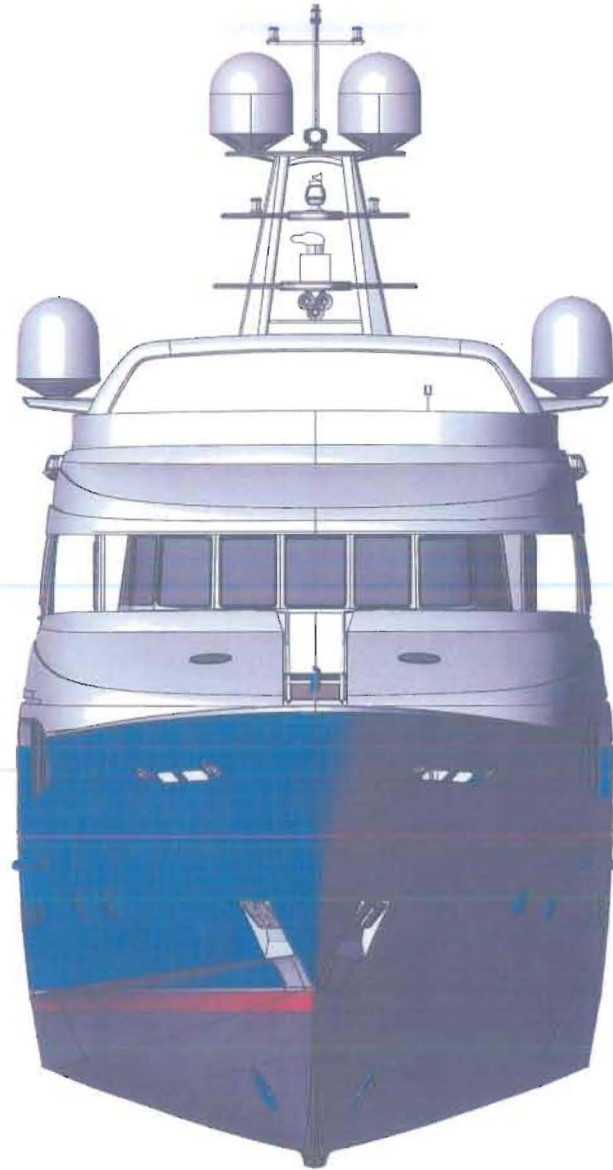
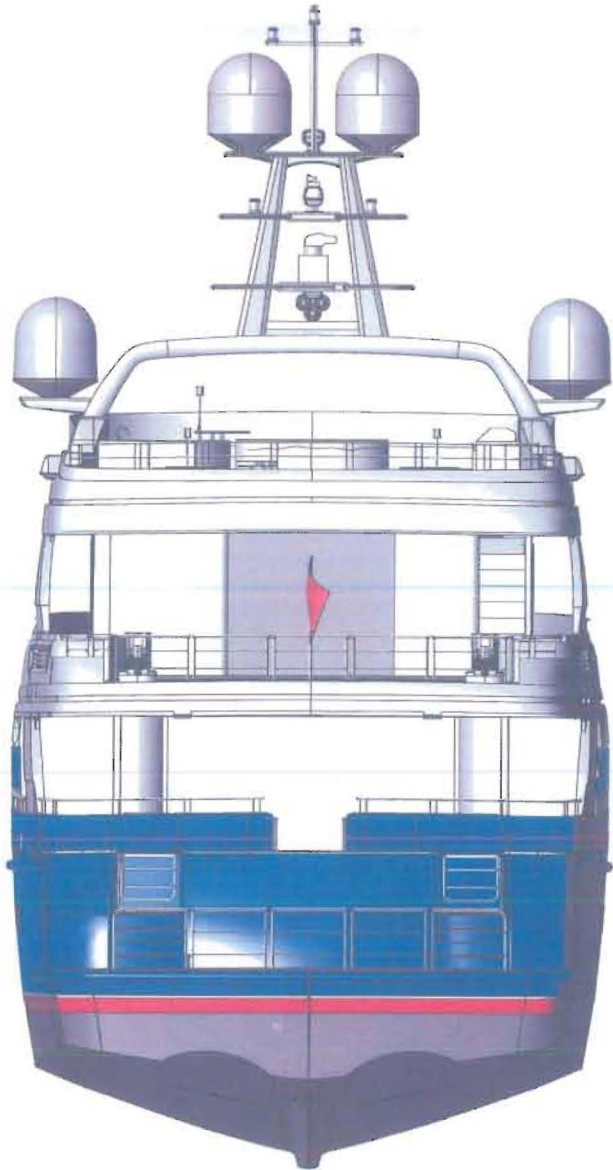

DVH 0406

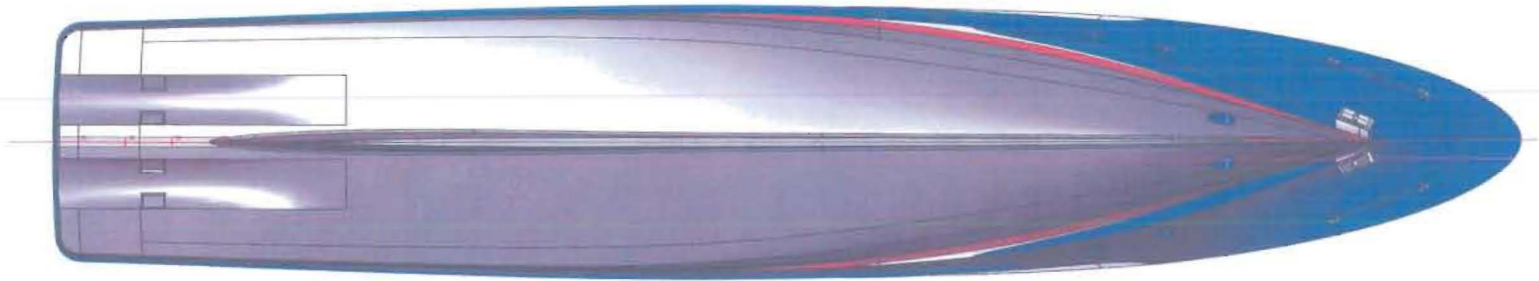
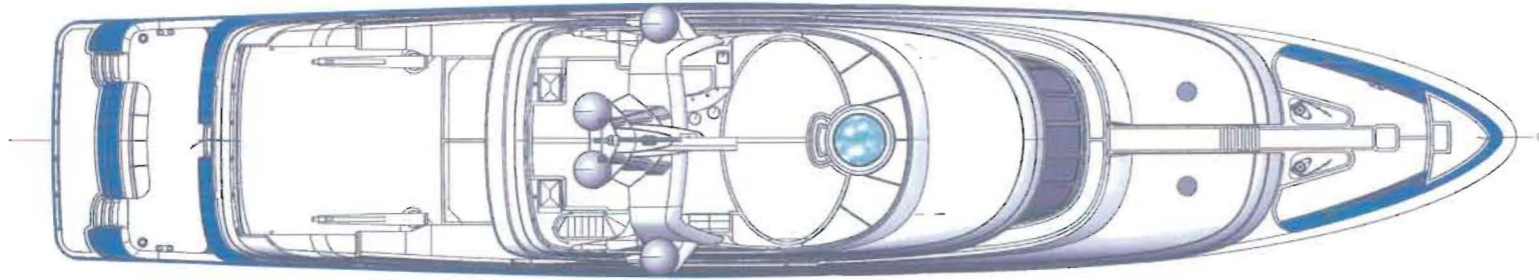

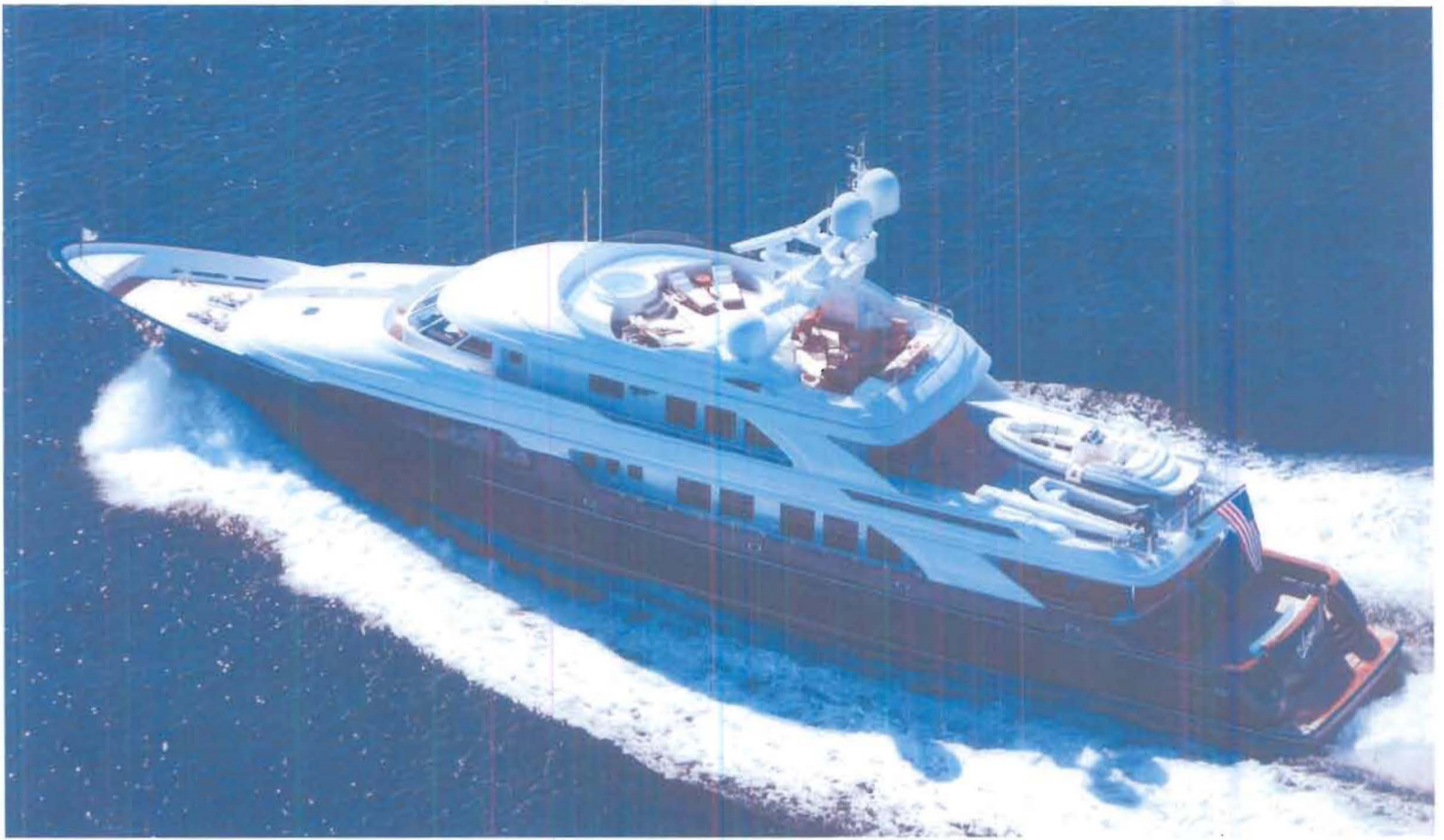

DVH 0406

